

**IT'S GOING TO BE COLD,
IT'S GOING TO BE DARK
AND IT'S GOING TO LAST
YOU FOR THE REST OF YOUR
LIVES!**

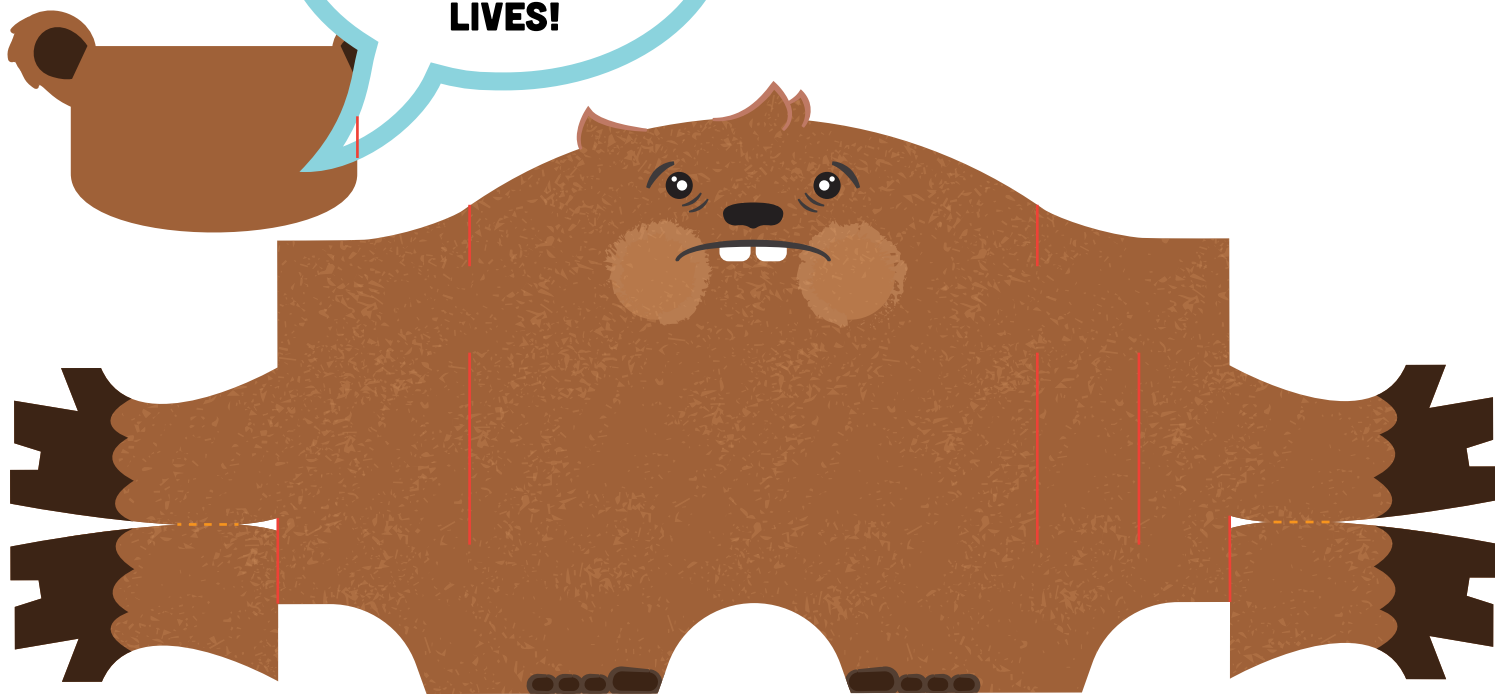

DIRECTIONS

- 1 Print File. Cardstock is preferred.

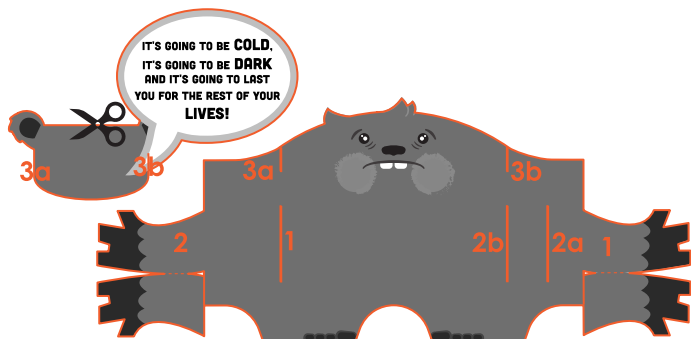

- 2 Cut out the Groundhog and its Ears/Speech bubble, be sure to cut along the red lines.

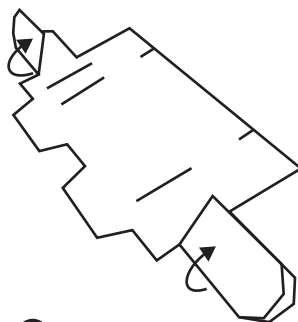

- 3 Fold back the arm flaps so the print is on the outside.

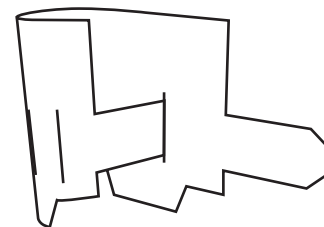

- 4 Insert arm 1 into slot 1.

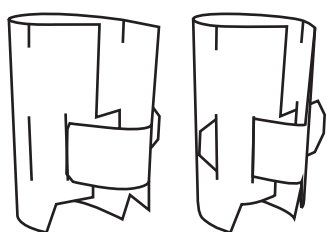

- 5 Insert arm 2 into slot 2a then into 2b.

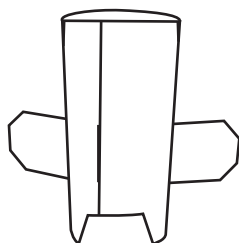

- 6 Gently pull arms until the back panel hits slot 2a.

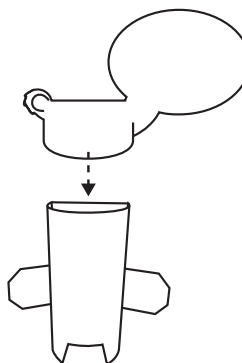

- 7 Slide slots 3a & 3b on horns onto slots 3a & 3b on body.



You just made a New Friend!